

Large Wind Tunnel (GroWiKa)

"GroWiKa" is the short form for "großer Windkanal" (big wind-tunnel) and indeed, the GroWiKa is **the biggest low-speed wind-tunnel** in the region Berlin/Brandenburg.

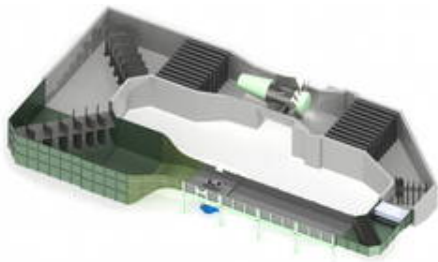

CAD-Modell des GroWiKa

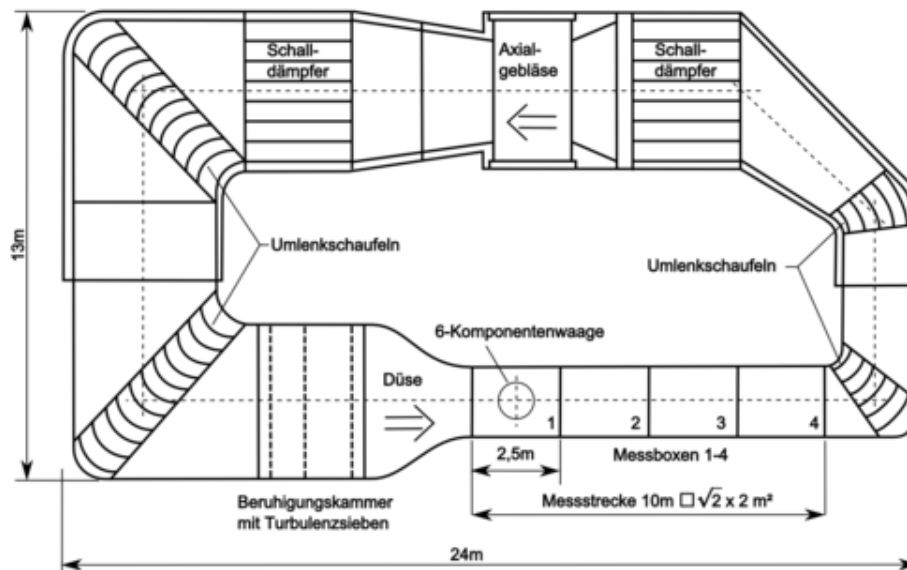

Großer Windkanal (GroWiKa) in der Halle des HFI



PKW-Modell im GroWiKa. Strömungssichtbarmachung mit Fäden.

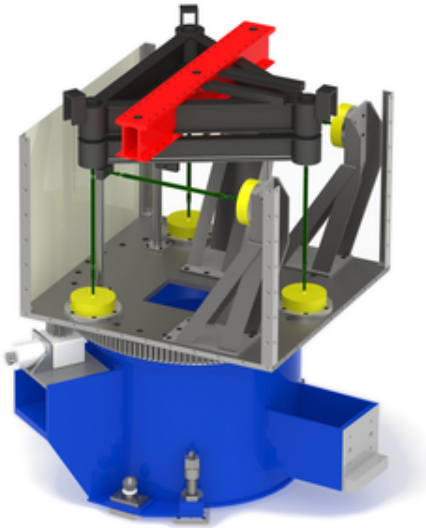

Die 6-Komponenten Waage erfasst alle Kräfte und Momente am umströmten Körper

Specifications

- Closed-Circuit wind tunnel
- Cross-Section of Test Sections:
 - Small: 2 m x 1.4 m
 - Large: 4.20 m x 4.2 m
- Length of Test Sections:
 - Small: 5 m, 7.5 m or 10 m
 - Large: 2.5 m or 5.0 m
- max. Velocity:
 - Small section: 70 m/s
 - Large Section: 11.0 m/s
- Contraction: 6.25 : 1
- Power: 450 kW
- Settling Chamber:
 - Cross-Section: 4.2 m x 4.2 m
 - Length: 5 m
- External 6-Component balance for precise measurement of all aerodynamic forces and moments on bodies in flow fields

Applications

- Investigation of the propagation of emissions gases
- Determination of forces acting on bodies in flows
- Determination of flow patterns around buildings
- Measurement of flow parameters
- Investigation of flow transitions
- Control of turbulent flows

CONTACT, INDEX AND FURTHER SERVICE

Last Update: 21.11.2018

CONTACT, SITEMAP AND FURTHER SERVICE LINKS